

› Pneumatic Ball Valve

R B V

Unique design and high platform structure.
ISO5211 connection, easy to be installed.

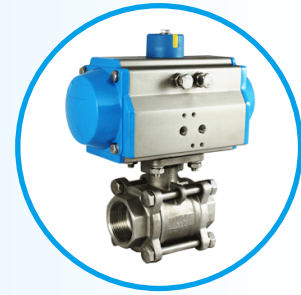

Order Code

R	BV	□	□	□	□	□□	□
KZE Product	Ball valve	Type P pneumatic L Lever	Connection 1 Female thread connection 2 male thread connection 4 Flanged connection 7 wafer type	Structure 1 Straight bore 2.Y 3-way Y type 4.L 3-way L type 5.T 3-way T type	Tandem Structure 1 1PCS type 2 2PCS type 3 3PCS type Blank Other	Nominal Diameter 08 : 1/4" 10 : 3/8" 15 : 1/2" 20 : 2/4" 25 : 1" 32 : 1/4" 40 : 1/2" 50 : 2" 65 : 2 1/4" 80 : 3" 100 : 4" 125 : 5" 150 : 6"	Valve body material Z CI Q DI P Stainless stell 304 R Stainless stell 316 C Carbon steel

Features

- Unique design and beautiful appearance
- High platform structure and ISO5200 connection, makes the installation of electric or pneumatic actuator to be more professional.
- Valve body is overlaid with reinforced bar, which can be permanently used in corrosion medium, and keep away from the cracking and failure during the installation
- Grinding process of the valve stem reduces the torque of electric or pneumatic valve during the installation.
- The valve body of carbon steel is phosphate coated, which won't be discolored and rusty. It is durable and beautiful.

Pneumatic Din Flange Ball Valve

Features

- The nominal pressure: PN 1.6, 2.5 Mpa
- Strength test pressure: PT2.4/3.8MPa
- Seal test pressure (low pressure): 0.6MPa
- Suitable medium: water.oil.gas.nitric acid.acetic acid
- Suitable temperature: -40~180°C
(WCB, Cf8, CF8M, Ti, Ni)
- GB: China national standard

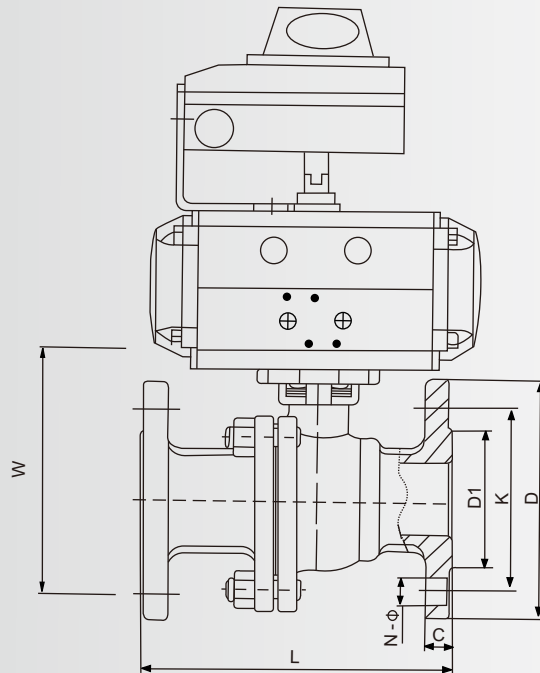

Model	INCH	DN	L	D	K	D1	C	W	N-φ	Actuator
RBVP41-2-15GB	½"	15	130	95	65	45	14	97	4-14	RAT052DA
RBVP41-2-20GB	¾"	20	140	105	75	45	14	110	4-14	RAT052DA
RBVP41-2-25GB	1"	25	150	105	85	65	14	115	4-14	RAT063DA
RBVP41-2-32GB	1-1/4"	32	165	135	100	78	16	140	4-18	RAT063DA
RBVP41-2-40GB	1-1/2"	40	180	145	110	85	16	170	4-18	RAT075DA
RBVP41-2-50GB	2"	50	200	160	125	100	16	165	4-18	RAT083DA
RBVP41-2-65GB	2-1/2"	65	220	180	145	120	18	195	4-18	RAT092DA
RBVP41-2-80GB	3"	80	250	196	160	137	20	220	8-18	RAT105DA
RBVP41-2-100GB	4"	100	280	217	180	156	20	250	8-18	RAT125DA
RBVP41-2-125GB	5"	125	320	245	210	185	22	380	8-18	RAT140DA
RBVP41-2-150GB	6"	150	340	280	240	210	24	470	8-23	RAT190DA
RBVP41-2-200GB	8"	200	400	335	295	265	26	626	12-23	RAT210DA

Pneumatic ANSI Flange Ball Valve

Features

- The nominal pressure : 150/300
- Strength test pressure : PT 3.0/7.5MPa
- Seal test pressure (low pressure): 0.6MPa
- Suitable medium: water.oil.gas.nitric acid.acetic acid
- Suitable temperature: -40 ~ 180°C
(WCB, CF8, CF8M,Ti, Ni)
- Ansi: American Standard

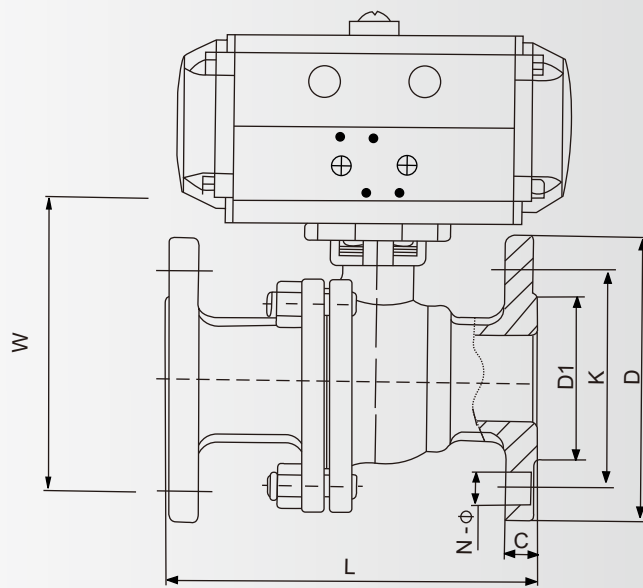

Model	INCH	DN	L	D	K	D1	N-φ	C	W	Actuator
RBVP41-2-15-ANSI	½"	15	105	89	60.5	35	4-15	10	100	RAT052DA
RBVP41-2-20-ANSI	¾"	20	116	98	70	43	4-15	11	108	RAT052DA
RBVP41-2-25-ANSI	1"	25	127	108	79.5	51	4-15	12	110	RAT052DA
RBVP41-2-32-ANSI	1-1/4"	32	140	117	89	64	4-15	13	165	RAT063DA
RBVP41-2-40-ANSI	1-1/2"	40	165	127	100	74	4-15	14.5	145	RAT075DA
RBVP41-2-50-ANSI	2"	50	178	152	120.5	92	4-19	16	165	RAT083DA
RBVP41-2-65-ANSI	2-1/2"	65	190	178	139.5	105	4-19	17.5	200	RAT092DA
RBVP41-2-80-ANSI	3"	80	203	190	152.5	127	4-19	19	225	RAT105DA
RBVP41-2-100-ANSI	4"	100	229	229	192	155	8-19	24	265	RAT125DA
RBVP41-2-125-ANSI	5"	125	356	254	216	186	8-22	24	380	RAT140DA
RBVP41-2-150-ANSI	6"	150	394	279	241.3	216	8-22	25.4	470	RAT190DA
RBVP41-2-200-ANSI	8"	200	457	343	298.5	270	8-22	29	626	RAT210DA

Pneumatic Female Thread 3-part Ball Valve

Features

- Screw type: NPT, BSPT, BSP
ISO-228 Class A Thread
- Temperature range: PTFE : -20°C~180°C
TFM : -50°C~270°C
RPTFE: -35°C~210°C
- Suitable medium: water, oil, air and some corrosive liquid
- Nomial pressure: 1000PSI (PN63) For ½" to 4"
- Blowout proof stem
- Locking device
- Material: CF8M 9(DIN I.4408)
Cf8 9DIN I .4308
WCB (DIN I.0619)
(WCB, CF8, CF8M/I. Ti. Ni)



No.	Component	Material	No.
1	Valve body	AISI 316	1
2	The sealing ring of the valve body	PTFE	2
3	Bolt washer	AISI 304	4
4	Screw cap	AISI 316	2
5	The sealing ring of the valve body	PTFE	2
6	Steam washer	Poly PTFE	1
7	Stem packing	PTFE	1
8	Packing gland	AISI 304	1
9	Valve stem	AISI 316	1
10	Valve body	AISI 316	1
11	Bolt washer	AISI 304	4
12	Six corner	AISI 304	4

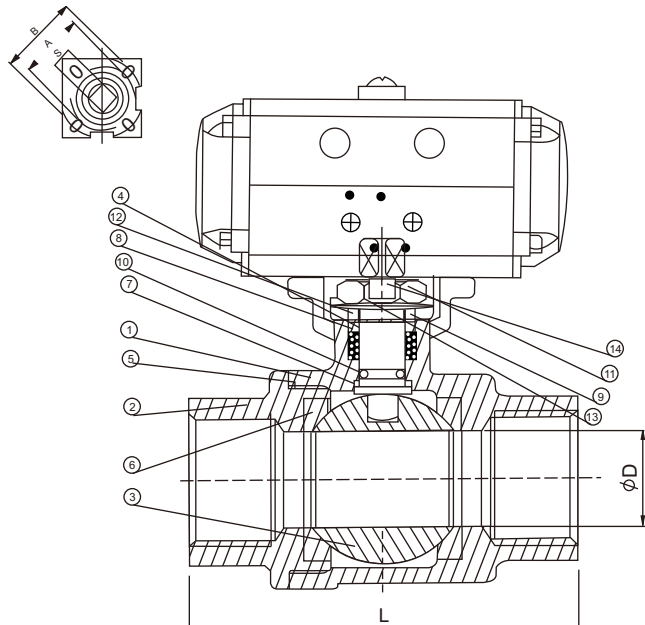

Model	Size/Dime	D	H	h	T	ISO-5211		S	Actuator
						A	B		
RBVP11-3-15	½"	15	38.8	5.5	5.7	70.6	F03 F04	9	RAT052DA
RBVP11-3-20	¾"	20	46	10	5.6	77.2	F03 F04	9	RAT052DA
RBVP11-3-25	1"	25	55.6	11	6	86.7	F04 F05	11	RAT052DA
RBVP11-3-32	1-1/4"	32	60.7	11.6	6	105	F04 F05	11	RAT063DA
RBVP11-3-40	1-1/2"	40	71.7	14.5	7	115	F05 F07	14	RAT075DA
RBVP11-3-50	2"	50	79	14	8	137	F05 F07	14	RAT083DA
RBVP11-3-65	2-1/2"	65	106.5	21.3	9.5	188.5	F07 F10	17	RAT092DA
RBVP11-3-80	3"	80	119.5	18	10	206.5	F07 F10	17	RAT105DA
RBVP11-3-100	4"	100	125	22	10	266	F10 F12	22	RAT125DA

Pressure temperature analysis diagram

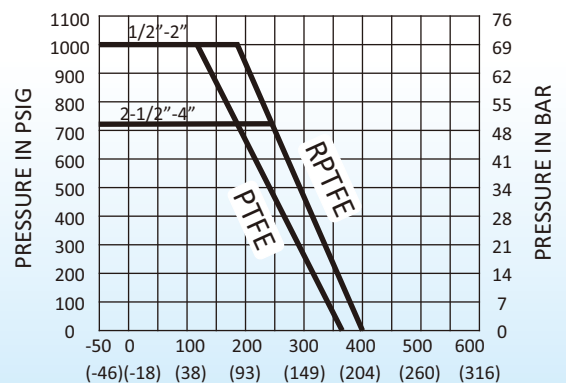

Pneumatic 3-Part Flange Ball Valve

Features

- The nominal pressure : PN 1.6, 2.5, 4.0, 6.4MPa
- Strength test pressure : PT 2.4, 3.8, 6.0, 9.6MPa
- Seal test pressure (low pressure): 0.6MPa
- Suitable medium: Suitable medium: water.oil.gas.nitric acid.acetic acid
- Suitable temperature: -40 ~ 180°C
- 3 Piece type flanged ball valve
(GB, ANSI, -JIS, DIN, SB)
(WCB, CF8, CF8M/I, Ti, Ni)

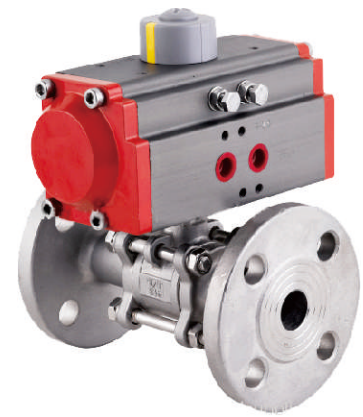

No.	Component	Material	No.
1	The ball	AISI 316	1
2	Valve seal	PTFE	2
3	Bolt	AISI 304	4
4	Valve cover	AISI 316	2
5	Valve seat	PTFE	2
6	Steam gasket	PTFE	1
7	O ring	PTFE	1
8	Stem packing	PTFE	1
9	Stem packing	AISI 304	1
10	Gland	AISI 304	1
11	Valve stem	AISI 316	1
12	Valve body	AISI 316	1
13	Stem gasket	AISI 304	4
14	Six corner	AISI 304	4

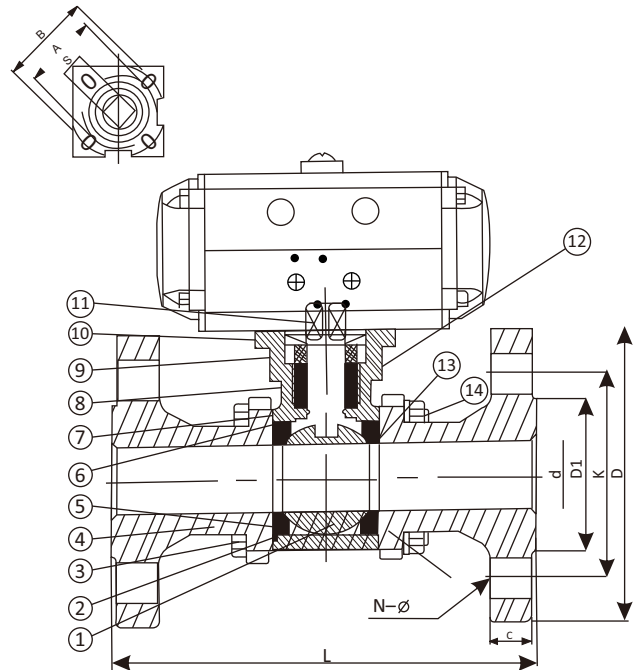

Model	DN	D	PN ANSI		D	K	D1	C	N-ø	Actuator
			L	L						
RBVP41-3-15	1/2"	15	130	108	95	65	45	16	4-14	RAT052DA
RBVP41-3-20	3/4"	20	150	117	105	75	58	18	4-14	RAT052DA
RBVP41-3-25	1"	25	160	127	115	85	68	18	4-14	RAT052DA
RBVP41-3-32	1-1/4"	32	180	140	140	100	78	18	4-18	RAT063DA
RBVP41-3-40	1-1/2"	40	200	165	150	110	88	18	4-18	RAT075DA
RBVP41-3-50	2"	50	230	178	165	125	102	20	4-18	RAT083DA
RBVP41-3-65	2-1/2"	65	250/290	190	185	145	122	22	8-18	RAT092DA
RBVP41-3-80	3"	80	280-310	203	200	160	138	24	8-18	RAT105DA
RBVP41-3-100	4"	100	320/350	229	235	190	162	24	8-22	RAT125DA

Pressure temperature analysis diagram
PRESSURE VS TEMPERATURE CHART

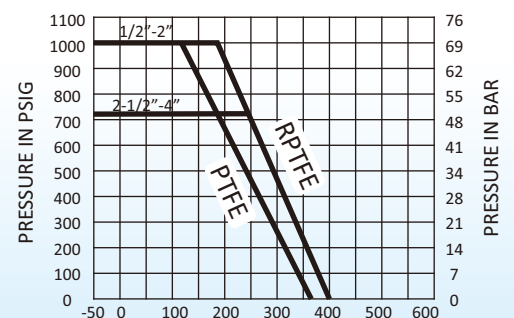

Pneumatic Female Thread 2-part Ball Valve

Features

- Screw type: NPT, BSPT, BSP
ISO-228 Class A Thread
- Temperature range: PTFE: -20°C~180°C
TFM: -50°C~270°C
RPTFE: -35°C~210°C
- Suitable medium: water, oil, air and some corrosive liquid
- Nomial pressure: 1000PSI (Pn63) For ½" to 3"
- Anti roll stem
- Locking device
- Material: CF8M 9(DIN I.4408)
CF8 9DIN I .4308)
WCB (DIN I.0619)
(WCB. Cf8. CF8M/I.Ti.Ni)



No.	Component	Material	No.
1	Valve body	AISI 316	1
2	The sealing ring of the valve body	PTFE	2
3	Bolt washer	AISI 304	4
4	Screw cap	AISI 316	2
5	The sealing ring of the valve body	PTFE	2
6	Steam washer	Poly PTFE	1
7	Stem packing	PTFE	1
8	Packing gland	AISI 304	1
9	Valve stem	AISI 316	1

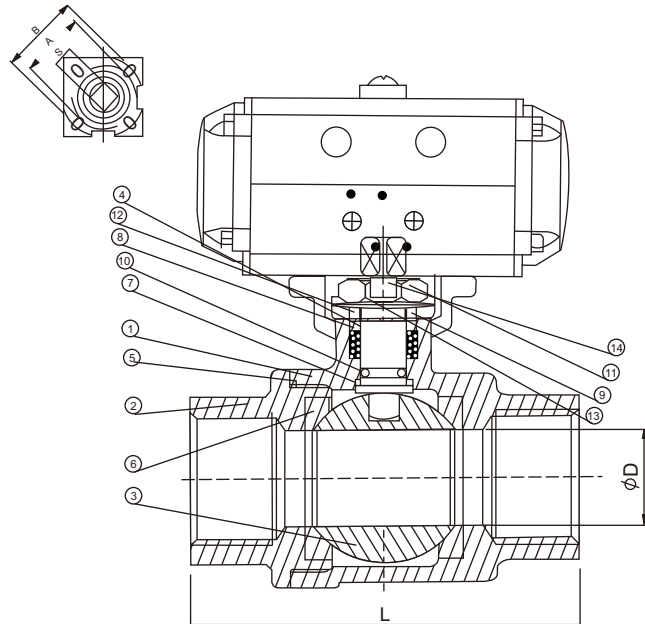

Model	Size/Dime	D	H	h	T	L	ISO-5211		S	Actuator
							A	B		
RBVP11-2-15	½"	15	39.5	6	5.6	39.5	F03	F04	9	RAT052DA
RBVP11-2-20	¾"	20	44	11.6	5.6	44	F03	F04	9	RAT052DA
RBVP11-2-25	1"	25	56	10	7.5	56	F04	F05	11	RAT052DA
RBVP11-2-32	1-1/4"	32	62	12.7	5.7	62	F04	F05	11	RAT063DA
RBVP11-2-40	1-1/2"	40	78.5	12	7	78.5	F05	F07	14	RAT075DA
RBVP11-2-50	2"	50	91	11.7	7.85	91	F05	F07	14	RAT083DA
RBVP11-2-65	2-1/2"	65	105	21	8.8	105	F07	F10	17	RAT092DA
RBVP11-2-80	3"	80	116.5	18.7	9	116.5	F07	F10	17	RAT105DA

Pressure temperature analysis diagram

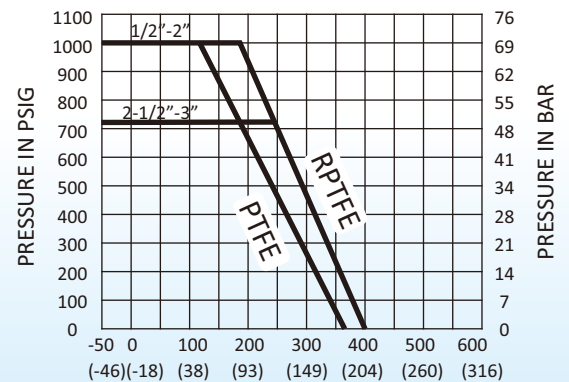

Pneumatic 3-Way Ball Valve

Features

- The nominal pressure : PN 1.6, 2.5, 4.0, 6.4MPa
- Strength test pressure : PT 2.4, 3.8, 6.0, 9.6MPa
- Sealed test pressure (low pressure): 0.6MPa
- Seal test pressure (pressure): 1.8, 2.8, 4.4, -7.1MPa
- Suitable medium: Suitable medium: water.oil.gas.
nitric acid.acetic acid
- Suitable temperature: -40 ~ 180°C
(WCB. Cf8. CF8M/l. Ti. Ni)



No.	Component	Material	No.
1	Valve body	AISI 316	1
2	Valve cover	AISI 316	2
3	The ball	AISI 316	4
4	Valve seat	PTFE	2
5	Valve seal	PTFE	2
6	Valve seat	PTFE	1
7	Stem packing	PTFE	1
8	Stem washer	AISI 304	1
9	Elastic washer	AISI 304	1
10	Valve stem nut	AISI 304	1
11	Valve stem	AISI 316	1

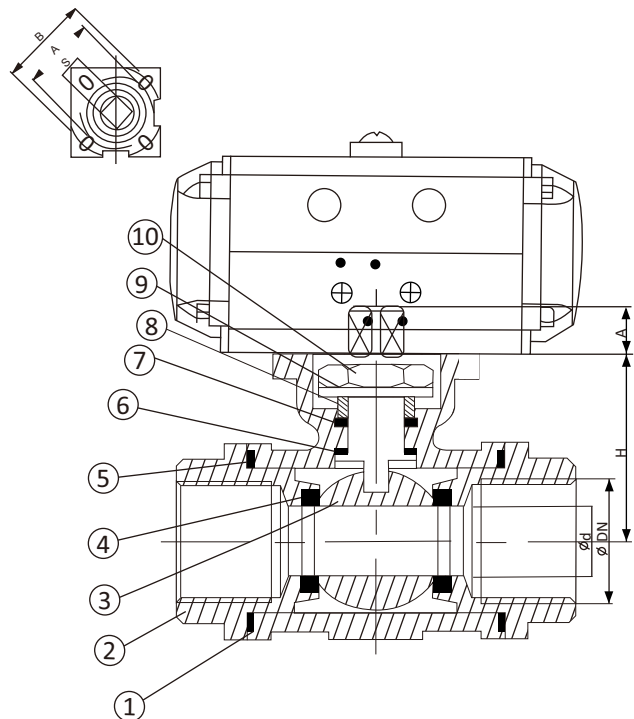

Model	d \ominus	L	H	h	B	A	S	T	DN	G	A1	Actuator
RBVP14-2-15	11.0	73.3	37	8.5	F04	F03	9.0	5	15	1/2"	69.5	RAT052DA
RBVP14-2-20	15.0	83.4	30	11.8	F04	F03	9.0	20	20	3/4"	74	RAT052DA
RBVP14-2-25	20.0	88.6	45	14.3	F05	F04	11.0	25	25	1"	85.5	RAT052DA
RBVP14-2-32	25.0	127	55	14.5	F05	F04	11.0	32	32	1-1/4"	105	RAT063DA
RBVP14-2-40	32.0	137.3	68	17.5	F07	F05	14.0	40	40	1-1/2"	126	RAT075DA
RBVP14-2-50	40.0	154	72.7	18.8	F07	F05	14.0	50	50	2"	137.8	RAT083DA

Pressure temperature analysis diagram

